

Application

Brio's Open Round Rail Top Fix Timber is an ideal internal system for residential and commercial applications of timber panels with exposed hangers and rail.

The easy to install hangers are 304 stainless steel with precision bearings.

Panel Specification

Track System:

For Individual Panels:

Max Panel Height
Max Panel Width
Max Panel Weight
Panel Thickness

Open Round Rail Timber Top Fix100

3000mm 9'10"
2000mm 6'6"
100kg 220lbs
35-44mm 1 3/8" - 1 3/4"

Standard Packs

Packs include 2 hangers, doorstops, guide, handle, brackets and fixings

Pack No.

ORT100
ORT100PR

Finish

Stainless Steel
PVD Black

Hardware Specification

Track:

Material
Standard lengths

100OR
Stainless Steel
2000mm 2500mm 3000mm 4000mm
6'6" 8'2" 9'10" 13'1"

Finishes

Stainless Steel and PVD Black
(except 4000mm, 13'1")

Guides:

Stainless precision bearing

106E/94

Channels:

Polypropylene
Aluminium
Finish
Standard lengths

94P Black
94PPA Aluminium Support & Polypropylene
Clear Anodised
2032mm 3048mm 4064mm 6096mm
6'8" 10' 13'4" 20'

Support Bracket:

Support bracket

100-RB or 100-RBPR

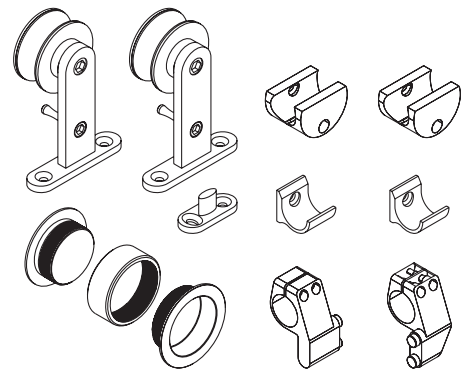
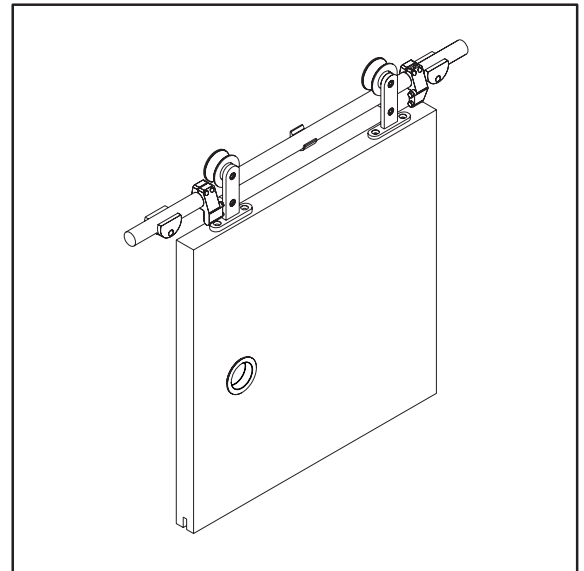

No. ORT100 HANGER SET

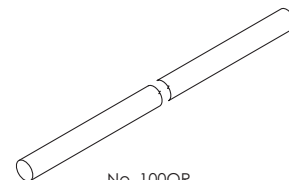

No. 100OR
ROUND RAIL



No. 100-RB
SUPPORT BRACKET

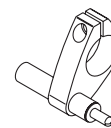

No. 100-LS
SOFT STOP LEFT

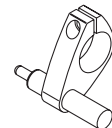

No. 100-RS
SOFT STOP RIGHT



No. 94P
CHANNEL

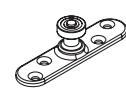

No. 106E/94
GUIDE

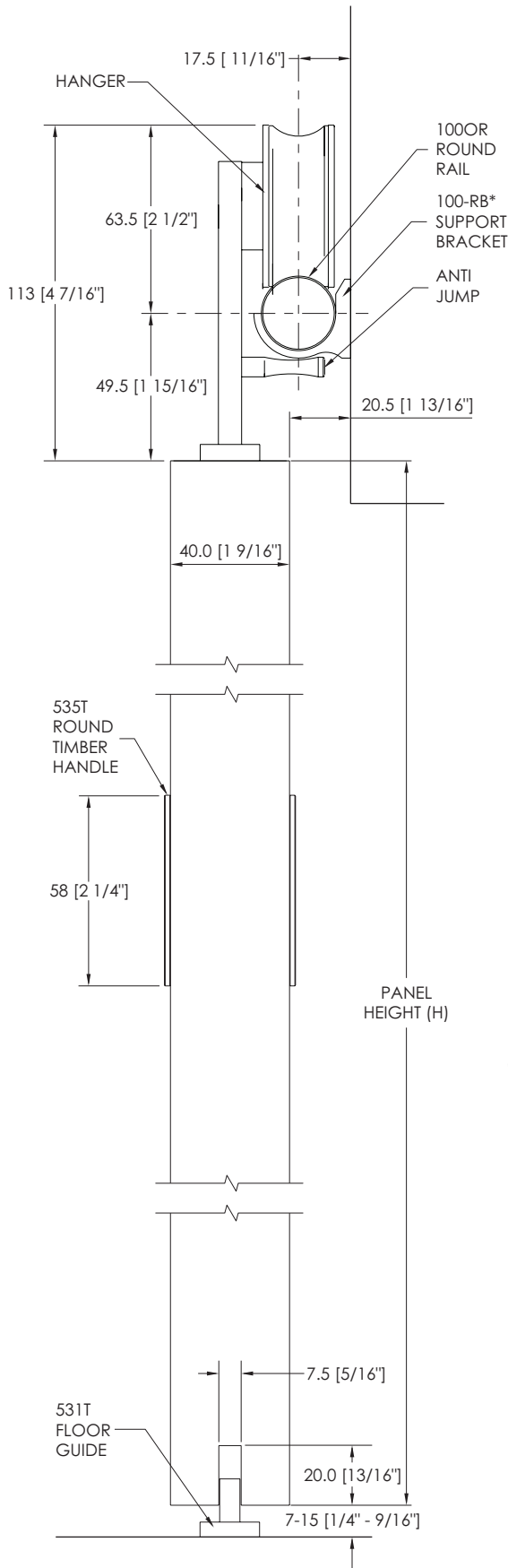

DOOR PREPARATION HANGERS

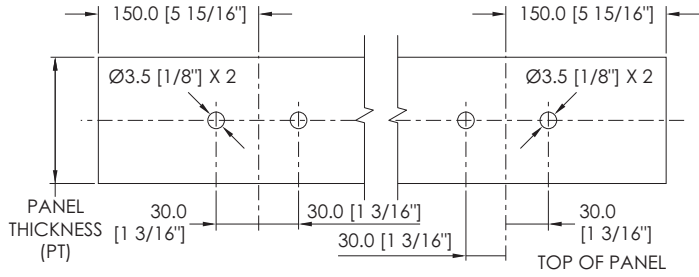

ROUND TIMBER HANDLE

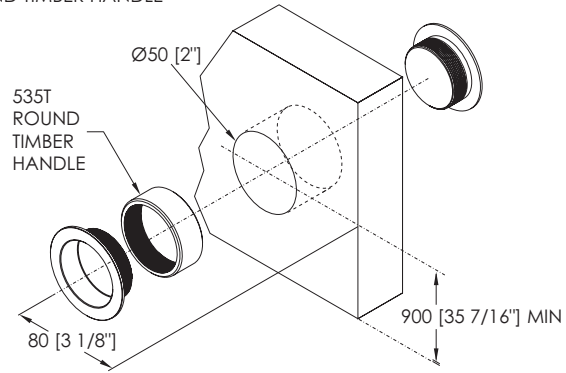

OPTIONAL GUIDES

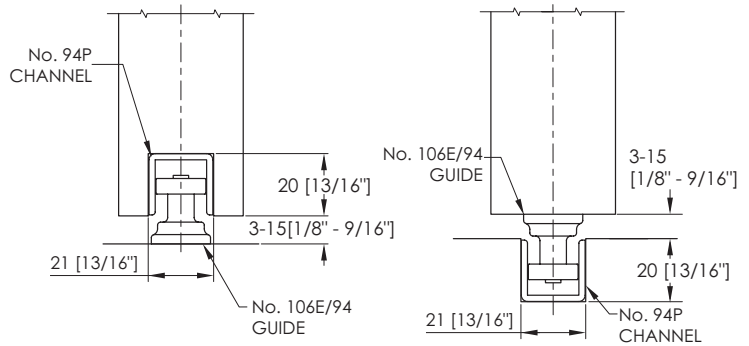

RAIL LENGTH	*ADDITIONAL 100-RB REQUIRED
2500 [98 7/16\"/>	1
3000 [118 1/8\"/>	2
4000 [157 1/2\"/>	4

Application

Brio's Open Round Rail Top Fix Timber is now available as a Face Fix hanger making it an ideal internal system for residential and commercial applications of timber panels with exposed hangers and rail.

Open Round Rail Timber Face Fix 100 hangers are 304 stainless steel with precision bearings.

Panel Specification

Track System: For Individual Panels:	Open Round Rail Timber Face Fix100	
Max Panel Height	3000mm	9'10"
Max Panel Width	2000mm	6'6"
Max Panel Weight	100kg	220lbs
Panel Thickness	35-40mm	1 3/8" - 1 1/2"

Standard Packs

Packs include 2 hangers, doorstops, guide, handle, brackets and fixings

Pack No.	Finish
ORF100	Stainless Steel
ORF100PR	PVD Black

Hardware Specification

Track:	100OR			
Material	Stainless Steel			
Standard lengths	2000mm	2500mm	3000mm	4000mm
	6'6"	8'2"	9'10"	13'1"
Finishes	Stainless Steel and PVD Black (except 4000mm, 13'1")			
Guides:	106E/94			
Stainless precision bearing				
Channels:	94P Black			
Polypropylene	94PPA Aluminium Support & Polypropylene			
Aluminium	Clear Anodised			
Finish				
Standard lengths	2032mm	3048mm	4064mm	6096mm
	6'8"	10'	13'4"	20'
Support Bracket:	100F-RB or 100F-RBPR			
Support bracket				

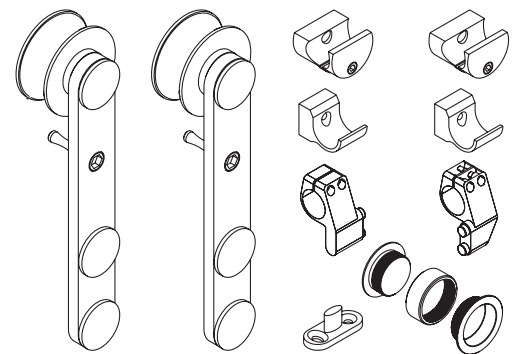
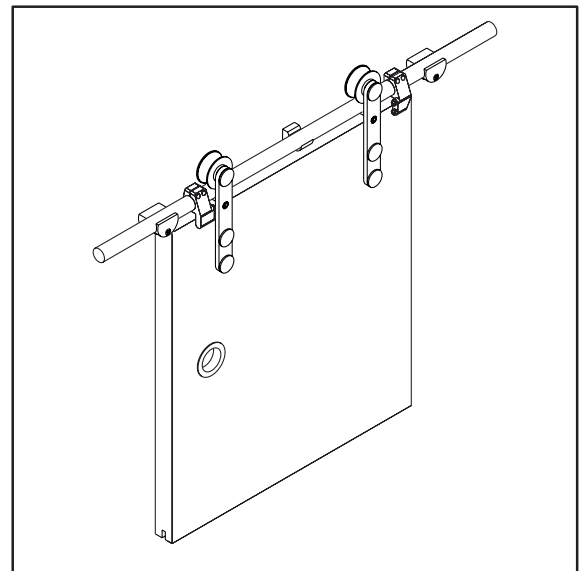

No. ORF100 HANGER SET

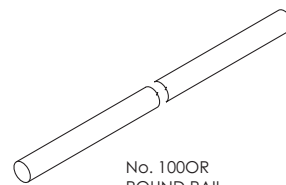

No. 100OR ROUND RAIL

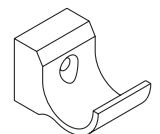

No. 100F-RB SUPPORT BRACKET

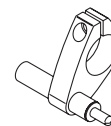

No. 100-LS SOFT STOP LEFT

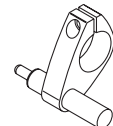

No. 100-RS SOFT STOP RIGHT



No. 94P CHANNEL

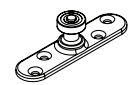

No. 106E/94 GUIDE

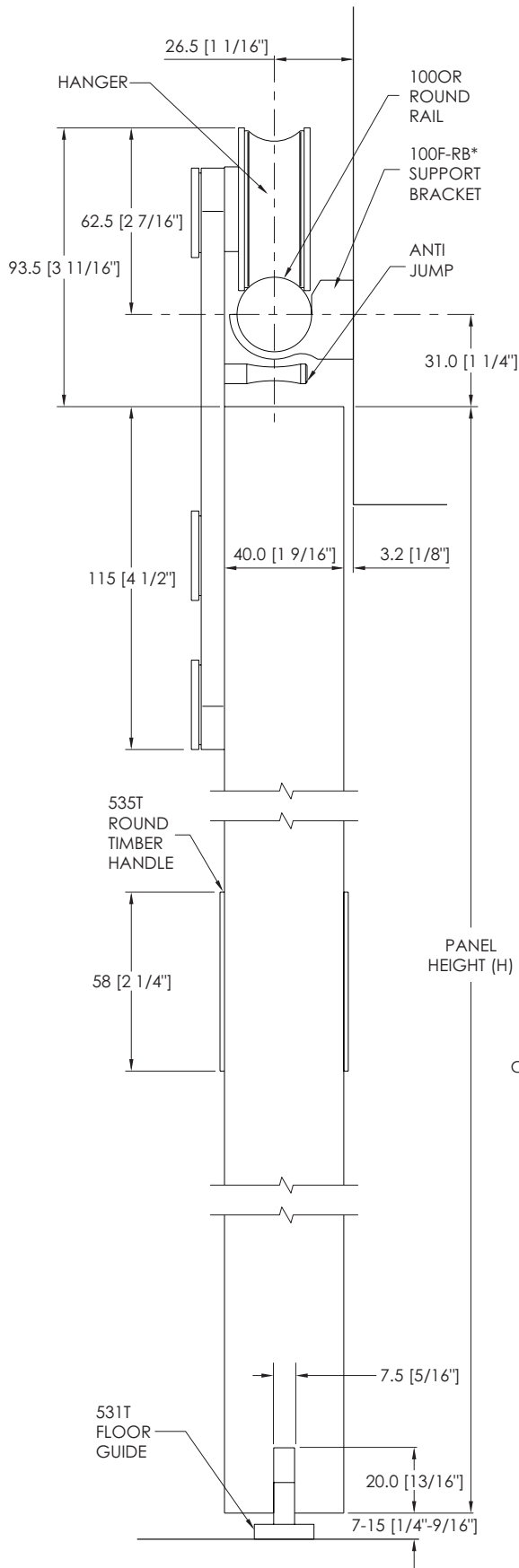

DOOR PREPARATION

HANGERS (INSIDE FACE OF DOOR SHOWN)

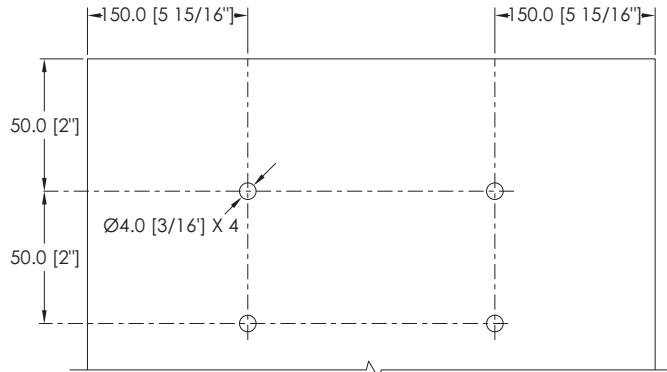

ROUND TIMBER HANDLE

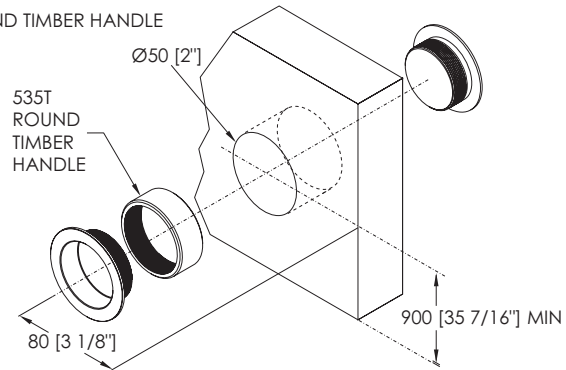

OPTIONAL GUIDES

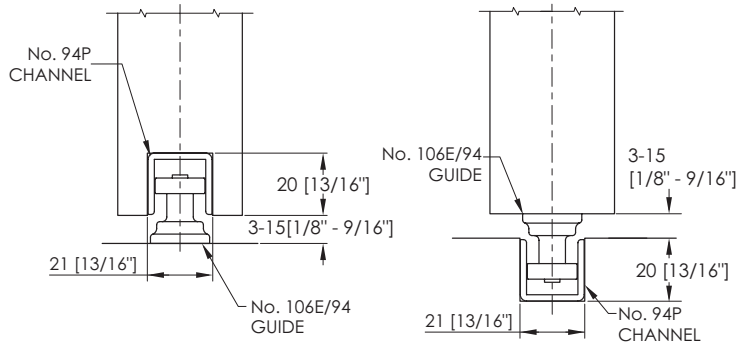

RAIL LENGTH	*ADDITIONAL 100F-RB REQUIRED
2500 [98 7/16"]	1
3000 [118 1/8"]	2
4000 [157 1/2"]	4